

Pinning Cross Walls

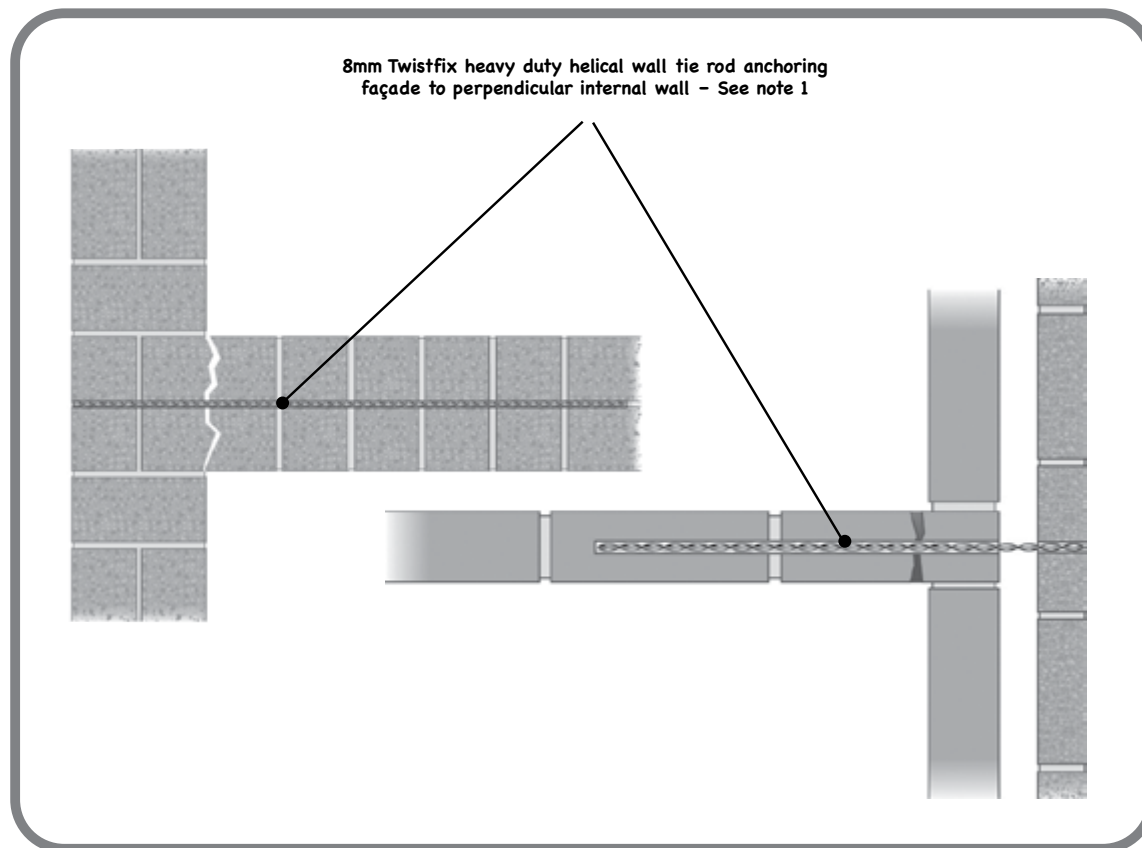

METHOD STATEMENTS & NOTES

1. Drill 14-16mm anchorage holes at least 500mm beyond cracked wall junction. Flush with clean water and fill hole with WHO-60 grout. Insert tie fully into grout and leave grout to set. Make good drill hole to match.

Ties should be spaced at 300mm centres vertically

REINFORCEMENT SPECIFICATION

- Material: 304 Series Stainless Steel
- Ult. Tensile Strength: 1050-1200N/mm²
- Nominal CSA: 8mm Bar = 12.5mm²

GROUT SPECIFICATION AT 28 DAYS

- Compressive Strength: 55N/mm²
- Tensile Strength: 5N/mm²
- Flexural Strength: 12N/mm²
- Youngs Modulus: 13N/mm²